

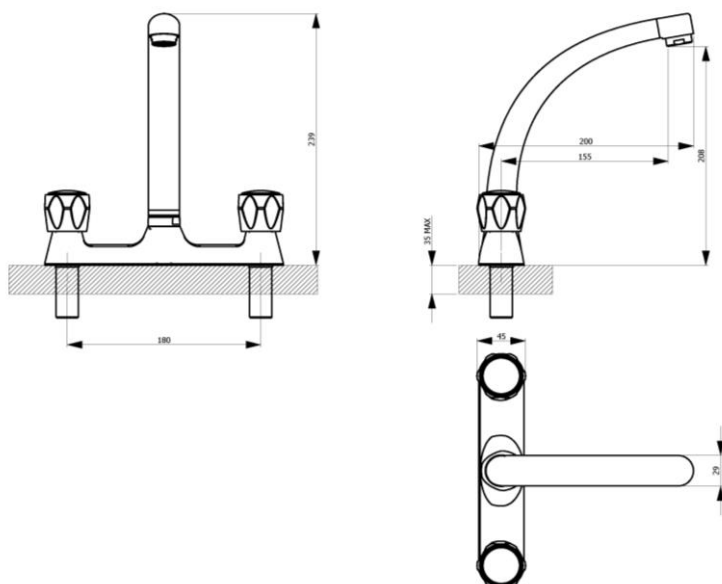

MERCIA MODERN

922095 – SINK MIXER

COMAP



Specification

Finish	Chrome
Body	Brass
Fittings	Metal backnut & washer
Connection	½" BSP threaded tail

Min dynamic pressure 0.1

Max dynamic pressure 6

Max static pressure 25

Max water temperature 60°C

Flow rates

Pressure	0.1	0.5	1	3
L/min	5.5	19.4	28.7	51.2

All Pressures are in Bar.

Dimensions supplied are nominal and subject to tolerance.

Inclusion of aerator (if supplied) or restrictors (sold separately unless stated) will affect flow rate result.

Performance details are based on trials under test conditions and for guidance only.

The Company reserves the right to change product specification without prior notice.

Features & Benefits



Guarantee



Low Pressure



Inlet Tail



Flow
Straightener



Flow Aerator



Single Flow

Certifications



Tested at 0.2 bar